

4IN BB Mecanum Wheel

Assembly Guide

Component	Part Number	QTY	Photo
BB Mecanum Plate	am-4734R_plate OR am-4734L_plate	2	
BB Mecanum Hub	am-4734_hub OR am-4735_hub OR am-4736_hub	1	
4in BB Mecanum Roller	am-3680	12	
3/8" Bearing	am-3681	24	
Brass Tube Axle	am-4764	12	
Screw M3-0.5 x 45mm	am-1659	12	
Nylock Nut, M3-0.5	am-1023	12	

Roller Assembly

Step 1: Press one 3/16" Bearing (am-3681) into either side of the 4in BB Mecanum Roller (am-3680).



Note: The outer race of the bearing should be flush with the end of the roller.

Step 2: Press one Brass Tube (am-4764) into the 4in BB Mecanum Roller.

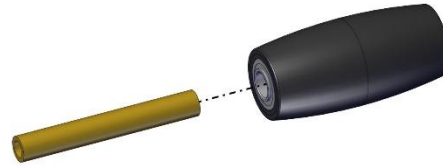

Step 3: Repeat for each of the 12 rollers on the wheel.



x12

Wheel Assembly

Note: A 4-wheel drive Mecanum Chassis requires 2 left wheels and 2 right wheels.

Step 1: Locate two left or two right plates. Each wheel will use two of the same plates on either side.



Note: Left plate shown, use two of the same plates on each wheel.

Step 3: Place one Roller Assembly between a plate tab pair and loosely secure using one M3-0.5 X 45mm Socket Head Screw (am-1659) and one M3 Nylock Nut (am-1023).

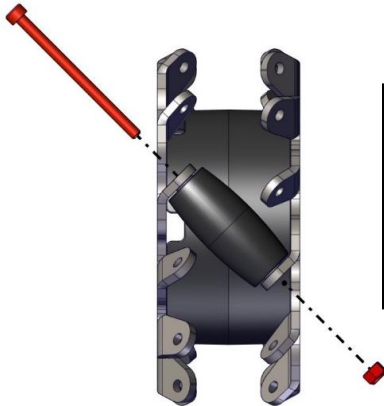

Note: AndyMark suggests installing the head of the screw on the inset side of the mecanum hub.

Step 5: Tighten all M3-0.5 X 45mm Socket Head Screws and M3 Nylock Nuts to lock all the wheel components in place.



Step 2: Place one 4in BB Mecanum Plate on either side of the 4in BB Mecanum Hub.

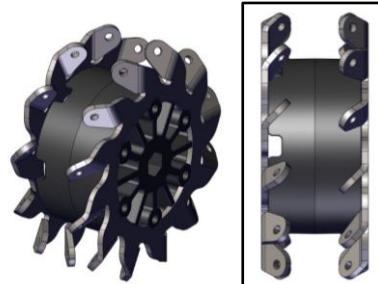

Note: Arrange plates with flanges bent in towards the hub.

Step 4: Repeat until all 12 rollers are in place. It is helpful to assemble rollers across from each other first to help hold the wheel together while assembling.

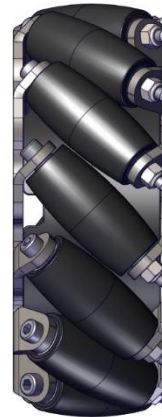

Step 6: Tighten all M3-0.5 X 45mm Socket Head Screws and M3 Nylock Nuts to lock all the wheel components in place.

